

LOK-IT HTI 700W/60/P50 10/CS 1/SKU



Product features and benefits

- Compact design and short arc gap allows for smaller and brighter fixtures
- Fast lamp replacement with one-touch rotate and lock base and socket design
- Robust design with eXtreme Seal (XS) technology, allowing up to 450°C at the pinch seal
- Consistent lumen output over the life of the lamp
- Improved ceramic base allows high voltage up to 35kV
- Higher luminous efficacy than conventional HID lamps provides higher fixture efficiency

Areas of application

- Concert Lighting
- Club & Disco
- Stage & Theatre
- Studio, TV, & Film
- Architecture & Architainment

Product datasheet

Technical data

General Product Information

Global order reference	Lok-it! HTI 700 W/60/P50
Product number (Americas)	4062172398909
Product name (Americas)	LOK-IT HTI 700W/60/P50 10/CS 1/SKU

Electrical Data

Nominal wattage	700 W
Nominal voltage	59.0 V
Nominal current	11.7 A

Photometric Data

Nominal luminous flux	49000 lm
Color temperature	5800 K
Color rendering index Ra	75
Light center length (LCL)	65.0 mm

Physical Attributes & Dimensions

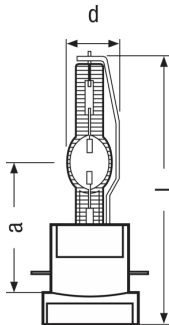

Electrode gap (cold)	4.1 mm
Lamp base	PGJX50
Diameter	25.0 mm
Length	125.0 mm
Product weight	130.00 g

Operating Conditions

Burning position	Any
------------------	-----

Lifetime Data

Product datasheet

Nominal lifetime	750 hr
------------------	--------

Environmental & Regulatory Information

Information according Art. 33 of EU Regulation (EC) 1907/2006 (REACH)	
Primary article identifier	4062172398909
Date of declaration	22-09-2024
Declaration no. in SCIP database	In work

Safety advice

Because of their high luminance, UV radiation and high internal pressure during operation, Lok-it! lamps may only be operated in enclosed lamp casings specially constructed for the purpose. Appropriate filters must ensure that UV radiation is reduced to an acceptable level. Mercury is released if the lamp breaks. Special safety precautions must be taken. Information on safety and handling is available on request or can be found in the leaflet included with the lamp or in the operating instructions.

Packaging Information

Product number	EAN/UPC	Packaging	Quantity	Outside dimensions L x w x h	Gross weight
4062172398909	4062172398909	SHIPPING BOX	1	7.2 in x 3.4 in x 2.3 in	0.4 lb

The mentioned product code describes the smallest quantity unit which can be ordered. One shipping unit can contain one or more single products. When placing an order, for the quantity please enter single or multiples of a shipping unit.