

LOK-IT HTI 700W/75/P50 1/CS 1/SKU



Product features and benefits

- Compact design and short arc gap allows for smaller and brighter fixtures
- Fast lamp replacement with one-touch rotate and lock base and socket design
- Robust design with eXtreme Seal (XS) technology, allowing up to 450°C at the pinch seal
- Consistent lumen output over the life of the lamp
- Improved ceramic base allows high voltage up to 35kV
- Higher luminous efficacy than conventional HID lamps provides higher fixture efficiency

Areas of application

- Concert Lighting
- Club & Disco
- Stage & Theatre
- Studio, TV, & Film
- Architecture & Architainment

Product datasheet

Technical data

General Product Information

Global order reference	Lok-it! HTI 700 W/75/P50
Product number (Americas)	54229
Product name (Americas)	LOK-IT HTI 700W/75/P50 1/CS 1/SKU
Family brand	HTI

Electrical Data

Nominal wattage	700 W
Nominal voltage	100 V
Nominal current	10.3 A

Photometric Data

Nominal luminous flux	50000 lm
Color temperature	7250 K
Color rendering index Ra	>75
Light center length (LCL)	65.0 mm
Light center length (LCL) - (in)	2.6 in

Physical Attributes & Dimensions

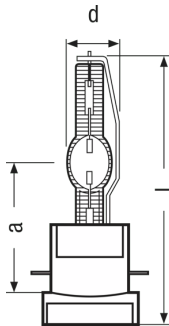

Electrode gap (cold)	4.0 mm
Lamp base	-
Diameter	25.0 mm
Length	125.0 mm
Product weight	140.00 g

Operating Conditions

Burning position	Other
------------------	-------

Product datasheet

Lifetime Data

Nominal lifetime	750 hr
------------------	--------

Environmental & Regulatory Information

Information according Art. 33 of EU Regulation (EC) 1907/2006 (REACH)	
Primary article identifier	4008321485205
Date of declaration	22-09-2024
Declaration no. in SCIP database	In work
Candidate list substance 1	No declarable substances contained

Safety advice

Because of their high luminance, UV radiation and high internal pressure during operation, Lok-it! lamps may only be operated in enclosed lamp casings specially constructed for the purpose. Appropriate filters must ensure that UV radiation is reduced to an acceptable level. Mercury is released if the lamp breaks. Special safety precautions must be taken. Information on safety and handling is available on request or can be found in the leaflet included with the lamp or in the operating instructions.

Packaging Information

Product number	EAN/UPC	Packaging	Quantity	Outside dimensions l x w x h	Gross weight
54229	4008321485205	SHIPPING BOX	1	7.2 in x 3.4 in x 2.3 in	0.5 lb

The mentioned product code describes the smallest quantity unit which can be ordered. One shipping unit can contain one or more single products. When placing an order, for the quantity please enter single or multiples of a shipping unit.